



TRICKS



RUNWAL BLISS

Lower Powai, Kanjurmarg East

Call Toll Free: 1800 102 3939

Email: contact@runwal.com | www.runwalbliss.com | SMS "Runwal" to 56161

Site Address - Runwal Bliss, Crompton Greaves Compound, Kanjurmarg (East), Mumbai - 400042.

Tel. : +91 22 6195 2400

Head Office - Runwal & Omkar Esquare 4th Floor, Off Eastern Express Highway,
Opp. Sion-Chunabharti Signal, Sion (East), Mumbai - 400 022.

Disclaimer: The plans, specifications, images and other details herein are only preliminary and the developer/owner reserves the right to change any or all of these in the interest of the development. This printed material does not constitute an offer and/or contract of any type between the Owner/Developer and the recipient. Any purchaser/lessee of this development shall be governed by the terms and conditions of the Agreement for Sale/Lease entered into between the parties and no details mentioned in this printed material shall in any way govern such transaction. The Developer reserves the right to change plans, specifications and features without prior notice or obligation at their sole discretion.



In constantly chasing the city life, we've forgotten the importance of just switching off for a while. Of getting a little breather. A blissful moment or two, just for ourselves.

Runwal Bliss, built around an ancient, 150-year old banyan tree, offers a well-deserved respite from this fast paced lifestyle.

- Like the roots of the banyan tree, Runwal Bliss is also well connected, both by road and rail to every part of Mumbai.
- It is said that entire ecosystems can thrive under a single banyan tree. In quite the same way, the well-planned infrastructure here includes access to quality schooling, colleges, hospitals, and Mumbai's best shopping/entertainment hubs in close vicinity.

ZRICH

36 acres
of pure bliss

Spread across 36 acres, Runwal Bliss holds the distinction of being one of the largest development in the eastern suburbs. The wide open expanse of green gives you the freedom to explore nature like no other place in Bombay. With Phase 1 having already been finalized and the rest of the area up for future development, Runwal Bliss will truly be a landmark unlike any other.





Welcome
to the
neighbourhood

Kanjurmarg

The undiscovered heart of the city

Kanjurmarg is fast growing to be a gem in the heart of the city. With the construction of the new Eastern Freeway providing quick connectivity to South Mumbai and the existing Eastern and Western expressways, along with the Jogeshwari-Vikhroli link road, this evolving destination is swiftly emerging as a better alternative to Powai.

By road, South Mumbai is less than 30 minutes via the new Eastern Freeway. The Western Suburbs can be reached via JVLR in 20 minutes. The International Airport/BKC via SCLR in 15-20 minutes. The Central suburbs via the Eastern Express Highway in 10 minutes and Navi Mumbai via the Airoli bridge in 20 minutes. And with the construction of the proposed Mumbai Metro line, Kanjurmarg also offers excellent connectivity by rail to all parts of Mumbai.

- Kanjurmarg Railway Station < 0.3 Km
- Bhandup Railway Station < 1 Km
- Eastern Express Highway < 1.5 Km
- JVLR < 1 Km
- R City Mall < 4 Km
- Multi-speciality Hospital (NABH) < 4 Km

ZRI

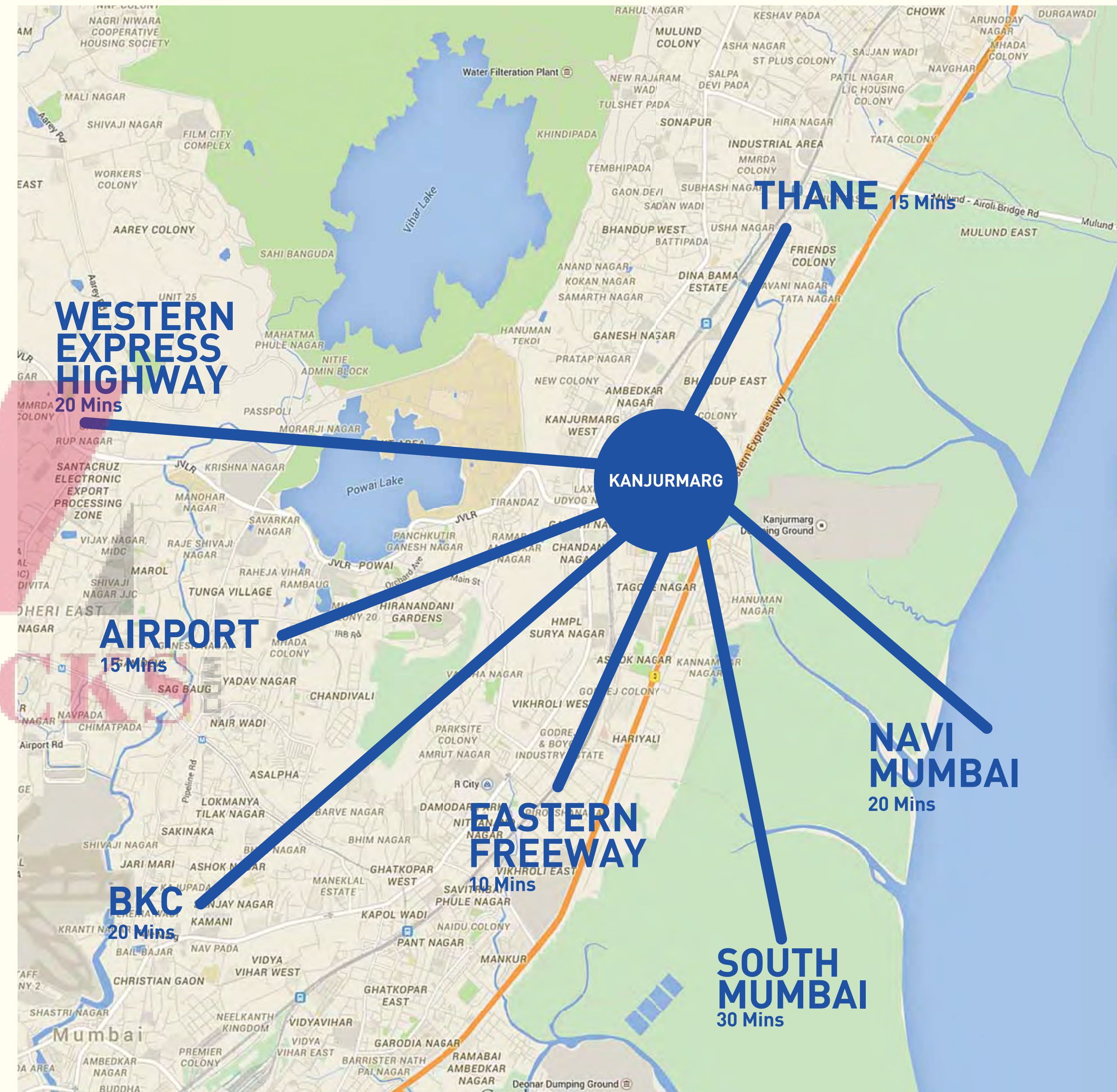

Location Map

SCHOOLS & COLLEGES

- Podar International School - 17 mins
- Bombay Scottish School - 22 mins
- IIT, Powai - 15 mins
- NITIE - 20 mins
- IBS Business School - 16 mins

SHOPPING MALLS & ENTERTAINMENT

- R City Mall - 15 mins
- Home Town - 08 mins
- D Mart - 07 mins
- Big Cinemas / Cinepolis - 05 mins
- Galleria, Powai - 14 mins

5 STAR HOTELS

- Radisson Blu - 05 mins
- The Renaissance - 25 mins

HOSPITALS

- Multi-speciality Hospital - 15 mins
- Fortis Hospital - 15 mins





WAL BLISS

A grand entrance...

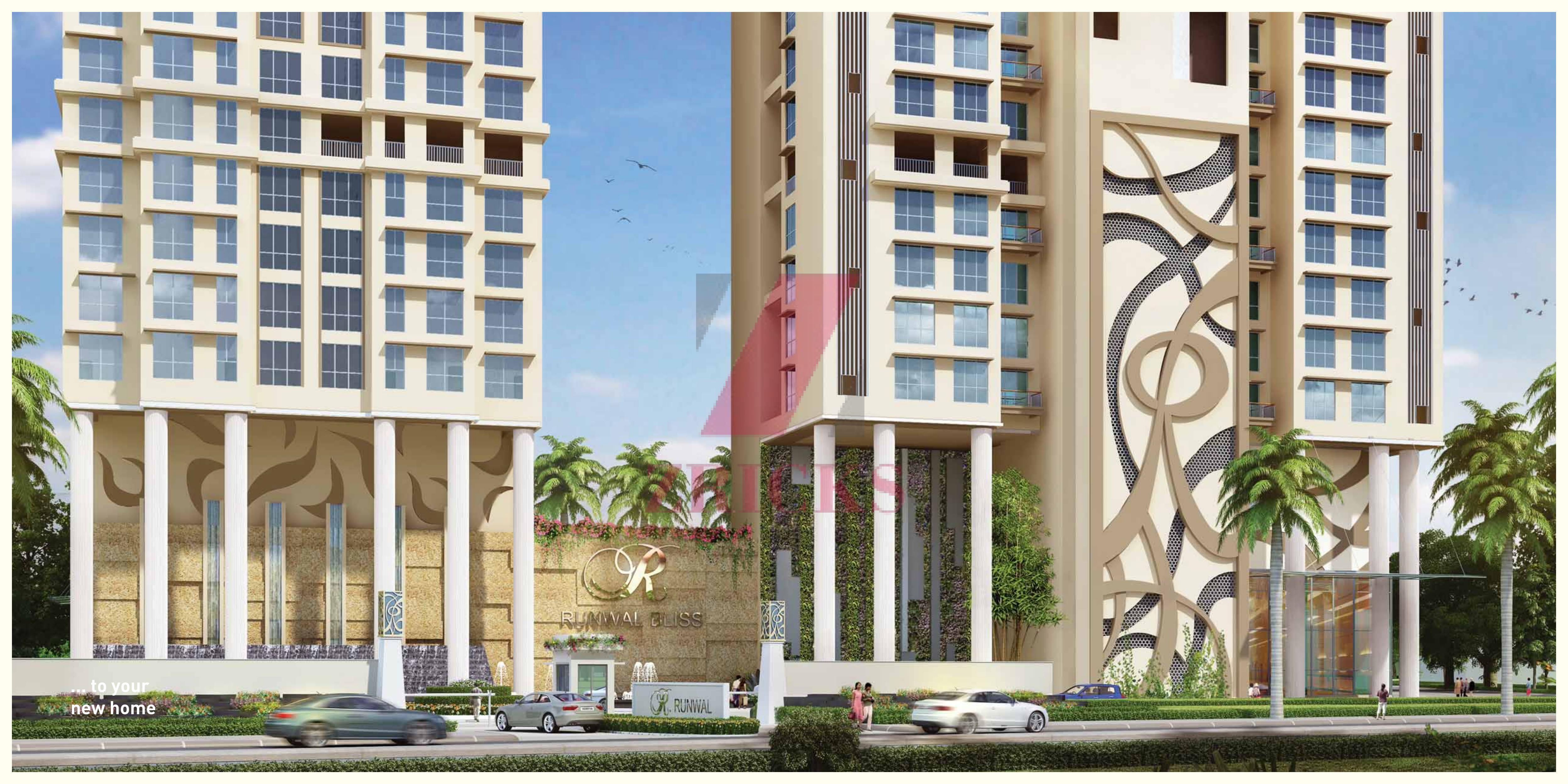

... to your
new home

R
RUNVAL BLISS

RUNVAL

Treat your eyes to a blissful view.



ZRICKS.COM

West view from
2 BHK apartments
of Ivy

East view from
3 BHK apartments
of Iris





RUNWAL BLISS

Lower Powai, Kanjurmarg East



2 BHK, 3 BHK, 4 BHK and 5 BHK apartments to meet the varying demands and tastes of our consumers. Set in the sanctuary of a 150 year old banyan tree, it is truly a world within itself.

Phase 1
(8 Acres)



Master
Layout

ZRICKS .COM

FUTURE DEVELOPMENT
(28 Acres)



Phase 1 Siteplan



Tower Nos.	Tower Name
1	Ivy
2	Daffodils
3	Iris
4	Marigold
5	Jasmine
6	Sunflower

- 1) Garden entry
- 2) Arrival plaza
- 3) Water fall
- 4) School bus stand
- 5) Pedestrian walkway
- 6) Drop off
- 7) Existing banyan tree with meditation area below
- 8) Kid's play area
- 9) Floral garden
- 10) Skating rink
- 11) Play field
- 12) Water cascade
- 13) Swimming pool
- 14) Yoga terrace garden over club roof
- 15) Cycle pedestrian path connecting the podium & ground level

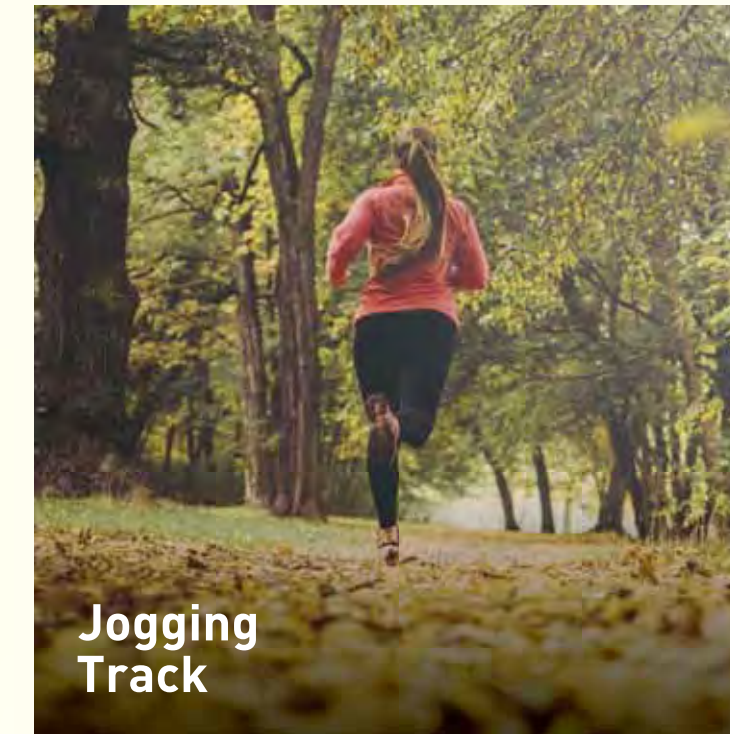

Jogging Track

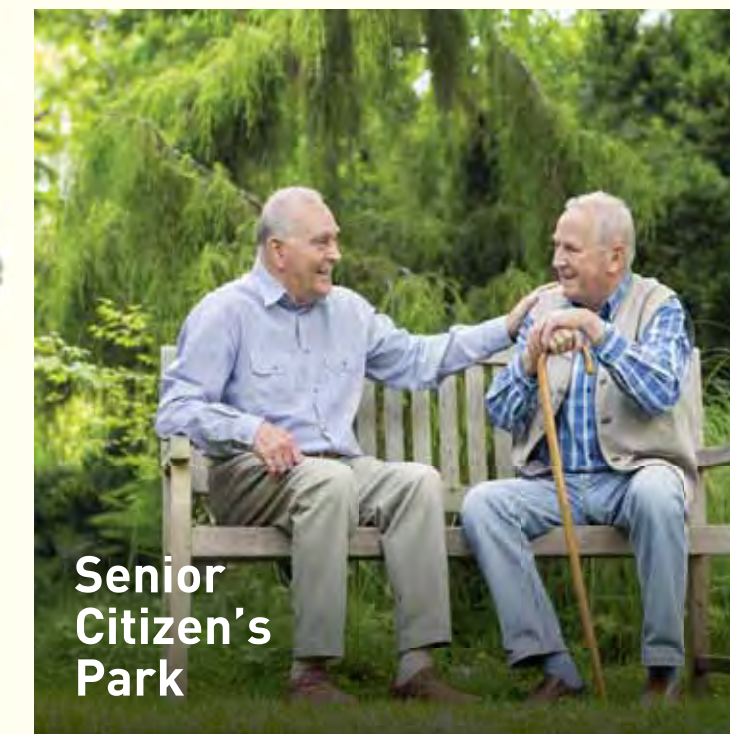

Senior Citizen's Park

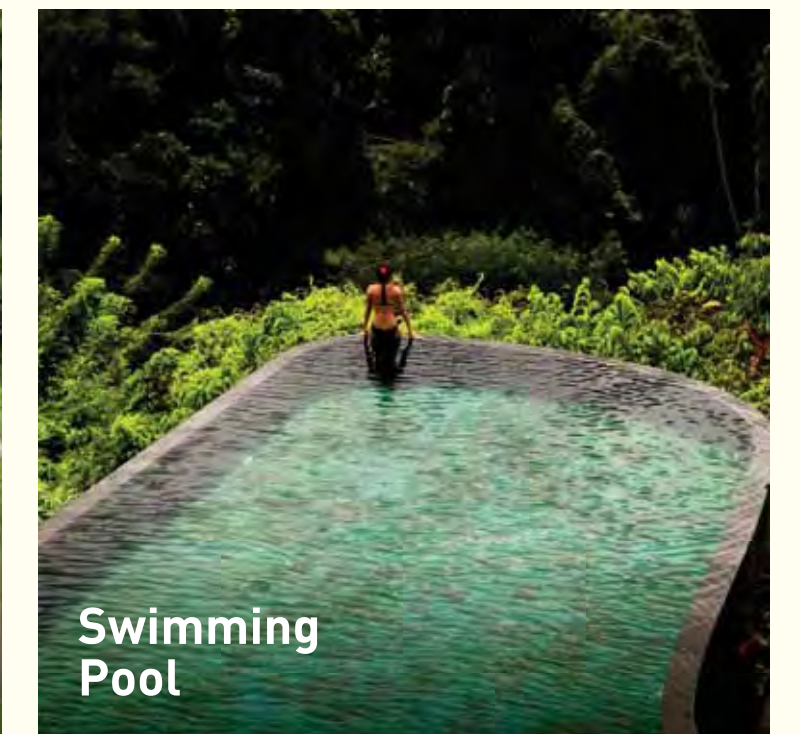

Swimming Pool



Amenities

A young girl with long brown hair, wearing a red and green striped sweater, is focused on building a structure with large, colorful plastic blocks. A young boy with blonde hair, wearing a green shirt, is also playing with the blocks. In the background, another child is visible, and there are bookshelves filled with books. The scene is set in a bright, warm environment.

Bliss Beanstalk

The grand banyan tree that resides in our premises offers an idyllic backdrop for the imagination of little children. Sometimes a playground, sometimes a wonderland, sometimes a place of learning. And to give them holistic avenues for learning we've designed Bliss Beanstalk. A host of facilities that gives their curious young minds a chance at wholesome nurturing.

Creche



Library



School Of Art & Music



Children's Playground

Let the kids and their imagination run wild. The sprawling greenery will be the perfect backdrop to every fantasy they conjure up. After all, childhoods need all the space they can get.



Kid's Play Area



Wholesome Recreation

Every day, Runwal Bliss offers you many opportunities to relax and soothe your mind and body. Set against the calming backdrop of the magnificent banyan tree, Runwal Bliss comes with myriad amenities to satisfy any kind of leisure. From spas and swimming pools to clubhouses and jogging tracks, you can unwind from the fast life and rejuvenate yourself. An everyday luxury to all the residents of Bliss.

Jogging & Cycling Track



Swimming Pool

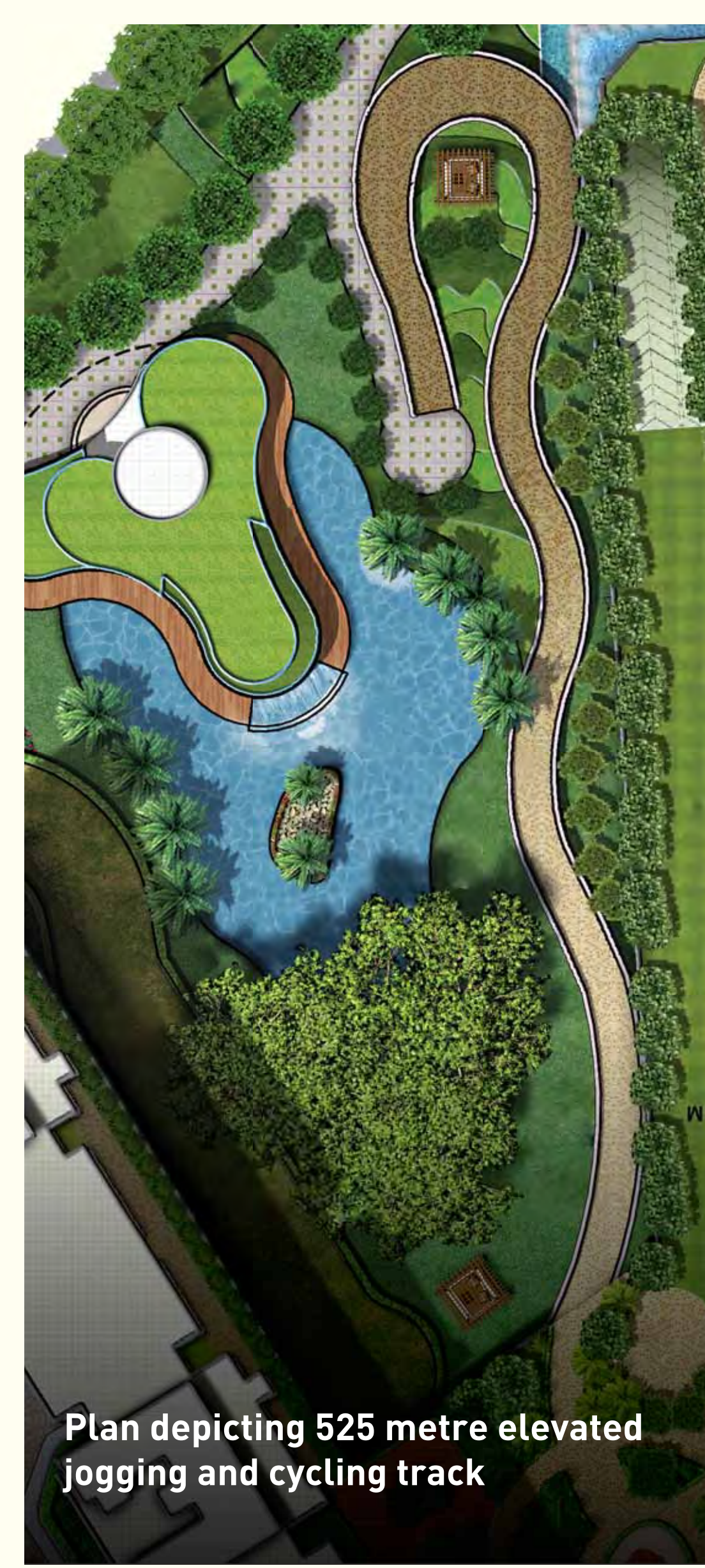

Plan depicting 525 metre elevated jogging and cycling track



Spa & Clubhouse

Exercise your body and mind in a state-of-the-art gymnasium. Or beat your stress at table-tennis, squash and badminton. And to top it off, rejuvenate the senses at the hands of your very own masseuse.

Gymnasium

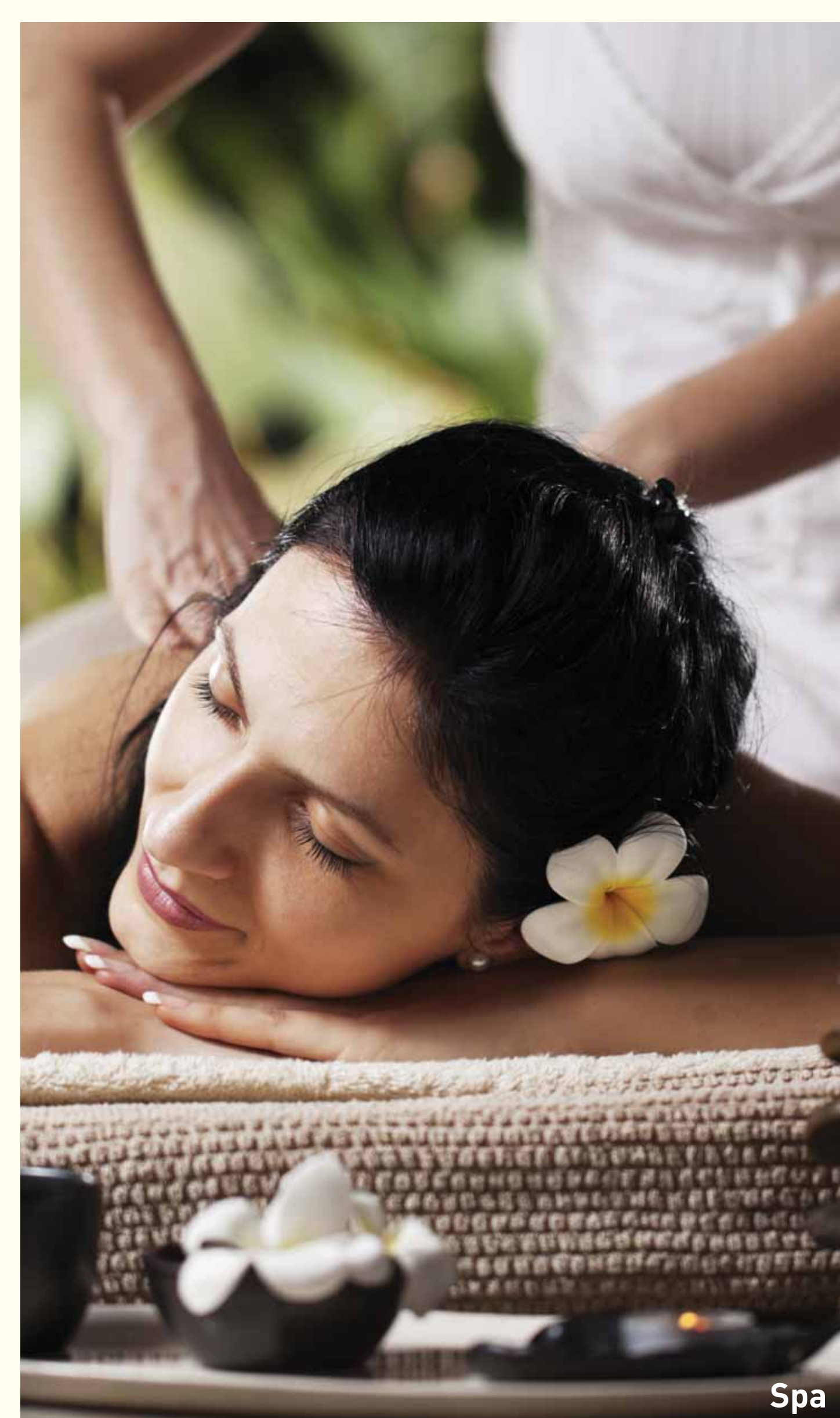

Spa



For the elderly

For those in the golden years of their life few things can be as soothing as sitting under the shade of the enchanting banyan tree. Whether you take a walk down memory lane or simply share an anecdote or two with some of your neighbours, our park's fresh scents and sounds are sure to keep you invigorated.

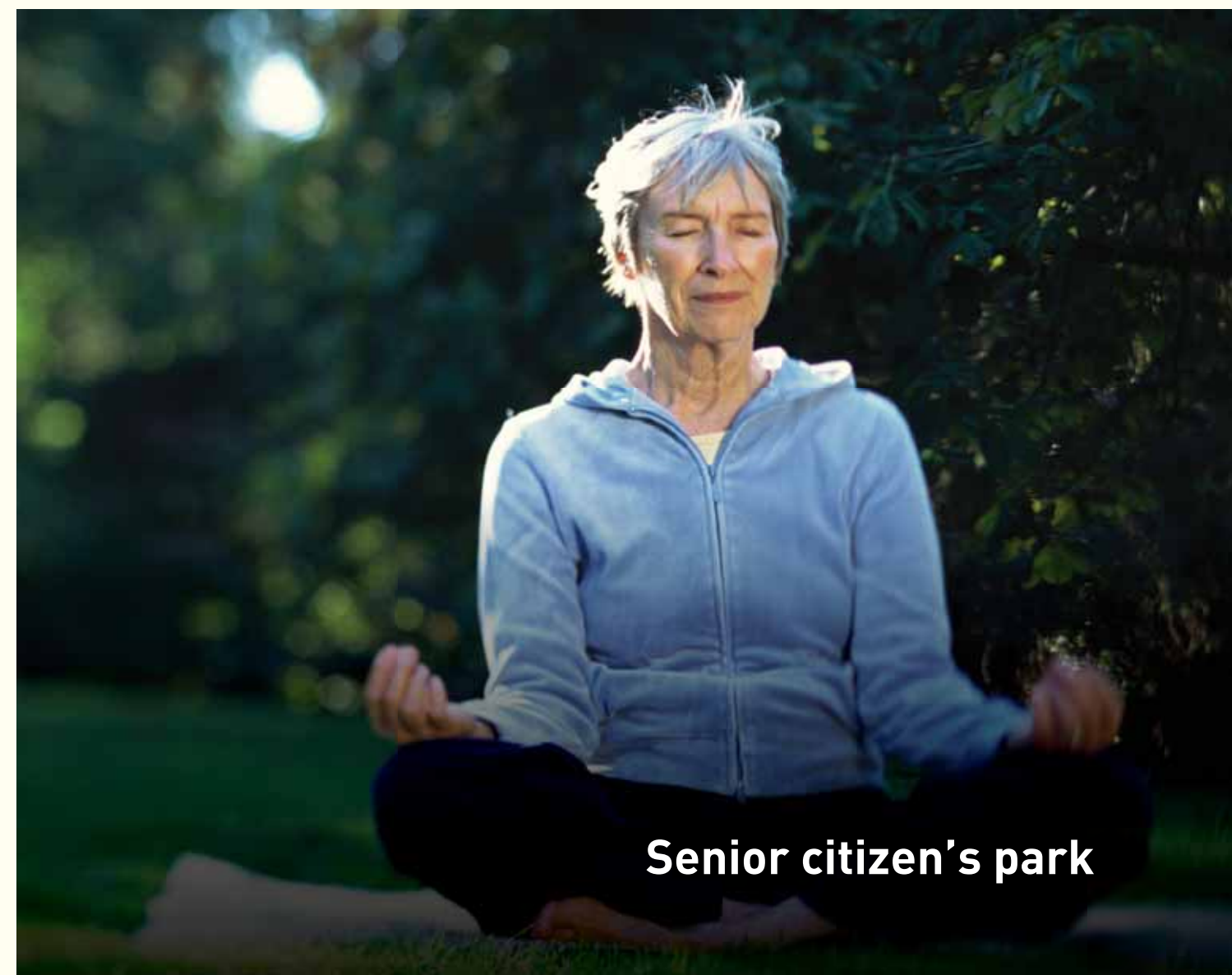

Senior citizen's park



Apartments

Images used are for indicative purposes only



Bedroom

Amenities include natural alarm clocks.

Cool wafts of the morning breeze to be more precise.

Waking up is always more refreshing the closer you are to nature.

And with elegant marble flooring and wide French windows to go with the beams of sunlight, your mornings will truly be filled with bliss.



Living Room

Introducing the best social networking site yet. Your living room.

Disconnect from the virtual and connect with the real world in the comfort of your home. With a delightfully spacious hall and cleverly designed aesthetics, it's the perfect place to experience the bliss of togetherness.



Kitchen

It is often said, the road to true bliss starts at the stomach.

There are no delights quite like gastronomical delights. And with enough fresh air, sunshine and serenity to add to every meal, life in a Bliss kitchen will be nothing short of nirvana.

AMENITIES OVERVIEW

EXTERNAL AMENITIES

- Grand entrance with double height
- Landscaped garden in 50% of plot area
- 500 meter long jogging & cycling track
- Basket ball and tennis court
- Water front cafeteria
- Badminton court
- Large kids play area
- Open air party lawn
- Dedicated senior citizen's park

Infrastructure

Facilities

- 100% power back-up in essential & common areas
- Provision for grocery store & pharmacy within the complex
- Sewage Treatment Plant (STP)
- Rainwater harvesting

Security Features

- Intercom facility from main gate to apartment
- Water sprinklers in case of fire
- Monitored access with CCTV surveillance and access control
- Video door phones at entrance with intercom facility

Services

- Car cleaning & servicing facility
- Security cabin
- Driver's sitting room with toilets

INTERNAL AMENITIES

Kitchen

- Exhaust fan
- Provision for water purifier & washing machine
- Polished granite kitchen platform with SS sink
- High end CP fitting
- Vitrified tile flooring
- Dado above platform
- Provision for piped gas

Bathroom

- Geyser & exhaust fan
- Full height designer tiles on wall
- Anti skid tiles on floor
- International standard sanitary fittings in all toilets
- Half shower partition in master bathroom for 3, 4 & 5 BHK
- High-end CP fittings with full height tiles

1.5 BHK & 2BHK

- Air-conditioned apartments
- 11 feet floor-to-floor height
- Wide French window
- Heavy-duty laminated wooden doors for all doors
- Laminated wooden flooring in master bedroom
- Vitrified flooring in living & bedrooms
- Utility area for washing machine
- Anti skid tiles in toilets

3 BHK, 4 BHK & 5 BHK

- Air-conditioned apartments
- 11 feet floor-to-floor height
- Wide French window
- Home automation system
- Teak wood for Entrance door & Heavy duty laminated wooden doors for all doors
- Italian marble in living room
- Laminated wooden flooring in master bedroom
- Modular kitchen
- Polished granite kitchen platform with SS Sink - Single bowl & single drain board
- Utility area / dry balcony in all flats
- Anti skid tiles in toilets & balcony
- Balcony - Engineered wooden floor

Club House

- Large club house – 12000 sq.ft.
- Large swimming pool with pool-side sitting area
- Wi-Fi enabled clubhouse
- Mini theatre
- Pool, snooker & table tennis
- Fully equipped gym
- Meditation & yoga centre
- Spa, steam, sauna & jacuzzi
- Music school
- Art school
- Library & Crèche
- Yoga pavilion on terrace
- Multi-purpose hall
- Squash court

GARDEN VIEW

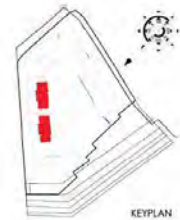

Configuration	Carpet Area(sq.ft.)	Tower No.	Tower Name
2 BHK (S)	670	1 & 2	Ivy & Daffodils
2 BHK (L)	753		

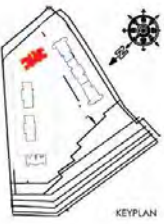

KEYPLAN



Configuration	Carpet Area(sq.ft.)	Tower No.	Tower Name
3 BHK (with deck)	1039	3	Iris
3 BHK (L)	1198		

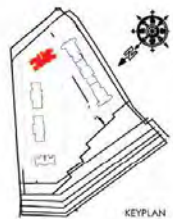

KEYPLAN



Configuration	Carpet Area(sq.ft.)	Tower No.	Tower Name
3 BHK (without deck)	988	3	Iris
3 BHK (L)	1198		

GARDEN VIEW

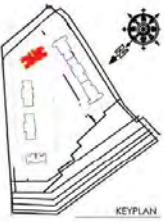

KEYPLAN



Configuration	Carpet Area(sq.ft.)	Tower No.	Tower Name
5 BHK	2355	3	Iris



Configuration	Carpet Area(sq.ft.)	Tower No.	Tower Name
4 BHK	1904	6	Sunflower
2 BHK (S)	670		
2 BHK (L)	753		



Configuration	Carpet Area(sq.ft.)	Tower No.	Tower Name
4 BHK	1904	4	Marigold
2 BHK (S)	670		
2 BHK (L)	753		



Configuration	Carpet Area(sq.ft.)	Tower No.	Tower Name
2 BHK (S)	670	6	Sunflower
2 BHK (L)	753		

Configuration	Carpet Area(sq.ft.)	Tower No.	Tower Name
2 BHK (S)	670	4	Marigold
2 BHK (L)	753		